

NOTES:

1.MATERIAL:

HOUSING: THERMAL PLASTIC, GLASS FILLED, UL94V-0, COLOR: BLACK,
 COVER: THERMAL PLASTIC, COLOR : BLACK
 TERMINAL: COPPER ALLOY

2.TERMINAL :

CONTACT AREA: GOLD PLATED.
 SOLDER TAIL: TIN, THICKNESS=1.27 MICRONS MINIMUM
 UNDER PLATE: NICKEL, THICKNESS=1.27 MICRONS MINIMUM

3.PACKAGING : TRAY

4.PRODUCT SPECIFICATION REFER TO PS-67490-00*

5 MATING PART 67490,67491,67811,47080 SERIES

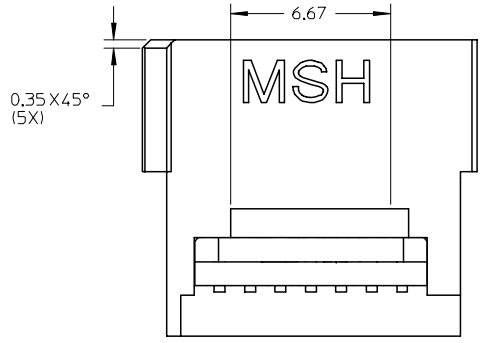
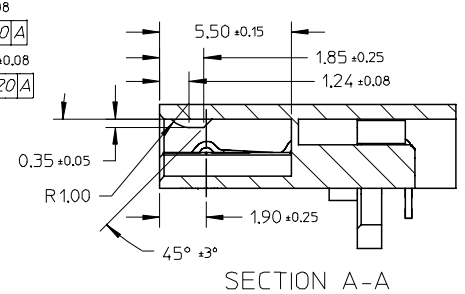
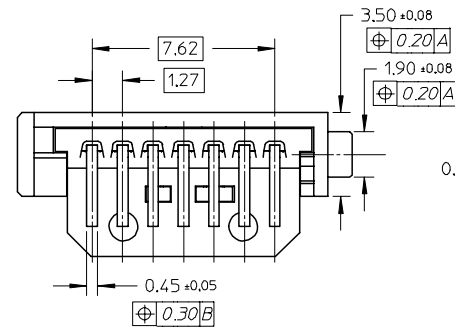
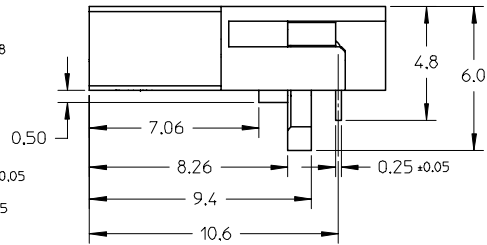
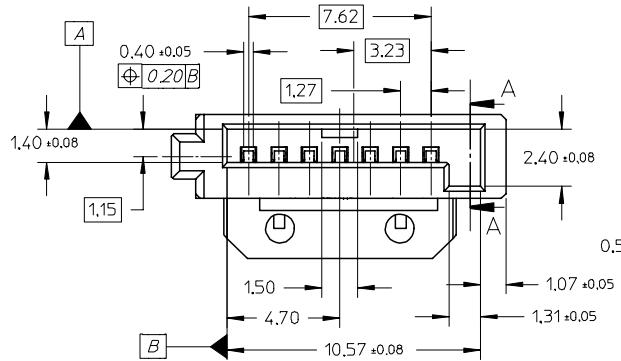

P/N	PLATING TYPE
67489-1001	GOLD FLASH
67489-1002	GOLD PLATED 0.76 MICRONS
67489-1005	GOLD PLATED 0.38 MICRONS

EC NO: SH2004-0185 DRWN:GRMA 2004/12/28 CHKD:GRATE 2004/12/30 APPR:YTYAP 2004/12/30	QUALITY SYMBOLS ▽ = 0 ▽ = 0	GENERAL TOLERANCES (UNLESS SPECIFIED)		SCALE 5:1	DESIGN UNITS METRIC	THIRD ANGLE PROJECTION REVISIONS ON CAD ONLY	
		mm	INCH	DIMENSION STYLE MM ONLY			
		4 PLACES	± ---	± ---	DRAWN BY GRATE MA	DATE 2004/03/25	TITLE SERIAL ATA RECEPTACLE SIGNAL CABLE CONNECTOR WITHOUT METAL LATCH
		3 PLACES	± ---	± ---	CHECKED BY YAJUN	DATE 2004/03/25	
2 PLACES	± 0.2	± ---	APPROVED BY SAM	DATE 2004/03/25	MATERIAL NO. SEE TABLE		
1 PLACE	± 0.3	± ---	ANGULAR ± 1 °		DOCUMENT NO. SD-67489-003	SHEET NO. 1 OF 2	
DRAFT WHERE APPLICABLE MUST REMAIN WITHIN DIMENSIONS		THIS DRAWING CONTAINS INFORMATION THAT IS PROPRIETARY TO MOLEX INCORPORATED AND SHOULD NOT BE USED WITHOUT WRITTEN PERMISSION					

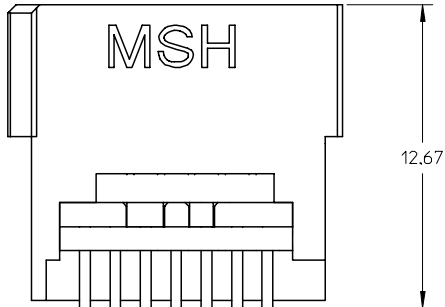
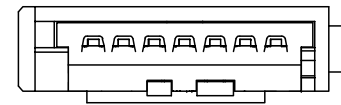
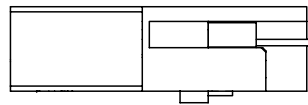
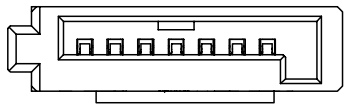
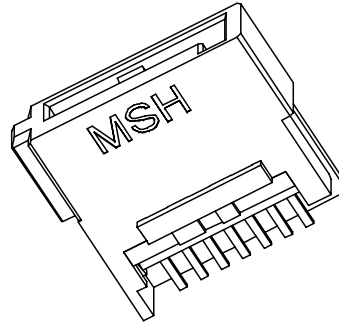
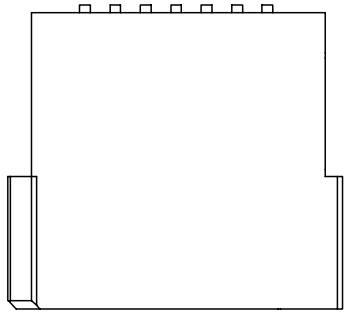

THESE ARE ONLY FOR 67489-800*, OTHERS INFORMATION ARE REFERED TO 67489-1001.

P/N	PLATING TYPE
67489-8001	GOLD FLASH
67489-8002	GOLD PLATED 0.76 MICRONS
67489-8005	GOLD PLATED 0.38 MICRONS

EC NO: SH2004-0185 DRWN: GRMA 2004/12/28 CHKD: GRATE 2004/12/30 APPR: YTYAP 2004/12/30	QUALITY SYMBOLS	GENERAL TOLERANCES (UNLESS SPECIFIED)		SCALE 5:1	DESIGN UNITS METRIC	THIRD ANGLE PROJECTION	REVISE ON CAD ONLY	
	DESCRIPTION ▽ = 0 ▽ = 0	4 PLACES	mm	INCH	DIMENSION STYLE MM ONLY		TITLE SERIAL ATA RECEPTACLE SIGNAL CABLE CONNECTOR WITHOUT METAL LATCH	
		3 PLACES	± ---	± ---	DRAWN BY GRATE MA	DATE 2004/03/25	MOLEX INCORPORATED	
		2 PLACES	± 0.2	± ---	CHECKED BY YAJUN	DATE 2004/03/25	MATERIAL NO. SEE TABLE	DOCUMENT NO. SD-67489-003
1 PLACE	± 0.3	± ---	ANGULAR ± 1 °	APPROVED BY SAM	DATE 2004/03/25	SHEET NO. 2 OF 2		
DRAFT WHERE APPLICABLE		MUST REMAIN WITHIN DIMENSIONS		THIS DRAWING CONTAINS INFORMATION THAT IS PROPRIETARY TO MOLEX INCORPORATED AND SHOULD NOT BE USED WITHOUT WRITTEN PERMISSION				